

# Rapid Response® Strep A Rapid Test Device

(Throat Swab)

INFECTIOUS DISEASES



The Rapid Response® Strep A Rapid Test Device is a rapid visual immunoassay for the qualitative, presumptive detection of Group A *Streptococcus* antigens in throat swab specimens. The test provides fast, reliable, and accurate results in just 5 minutes - empowering healthcare professionals with the information they need to make timely decisions about patient's health.

## Kit Content

- 25 individually packed test devices
- 1 Bottle of Reagent 1
- 1 Bottle of Reagent 2
- 25 Sterilized swabs
- 25 Nozzle with filter
- 25 Extraction tubes
- 1 Tube stand
- 1 Package insert
- 1 Positive control
- 1 Negative control

## Product Details

**Sample:** Throat Swab

**Format:** Strip

**Time-to-Result:** 5 minutes

**Storage Condition:** 36-86°F/2-30°C

**Test Principle:** Lateral Flow Assay

**Shelf Life:** 24 Months\*

\*From date of manufacture.

## Features

- No specialized training or equipment required
- Results in just 5 minutes
- Uses easy-to-collect throat swab specimens
- No cross-reactivity with 53 common respiratory tract organisms

Positive and negative controls included

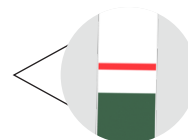

Internal procedural control on every strip

# Strep A Rapid Test Device



## Testing Procedure

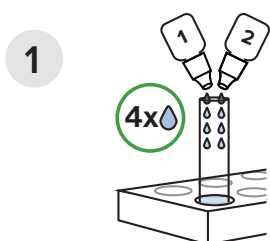

1 Add 4 drops of Reagent 1 and 4 drops of Reagent 2 to a clean extraction tube.

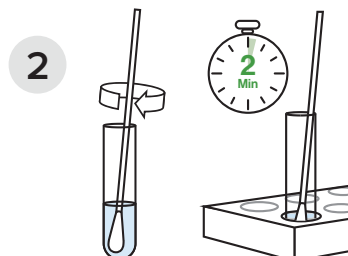

2 Place the swab with the collected specimen in the tube. Roll the swab against the sides of tube to release the liquid. Let stand for 1-2 minutes.

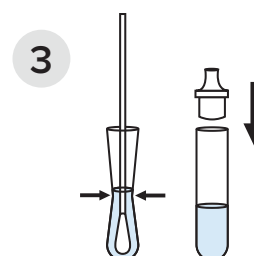

3 Remove the swab while squeezing the tube to expel liquid. Attach the nozzle.

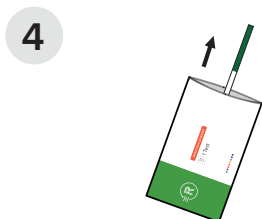

4 Remove the test from the pouch.

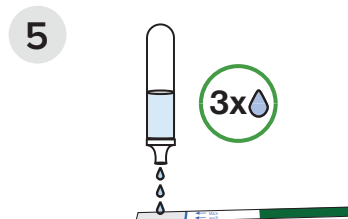

5 Add 3 drops of extracted solution onto the sample region on the test device.

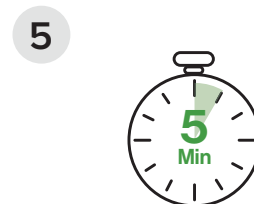

5 Read the results at 5 minutes.

For illustrative purposes only. Please read the insert supplied with the test for more detailed instructions before use.

## Results Interpretation



**POSITIVE:**  
Two coloured bands appear.



**NEGATIVE:**  
Only one coloured band appears  
in the control region (C).



**INVALID:**  
Control band fails to appear.

### Accuracy

97.4%

**Relative Sensitivity**  
(93.6%~99%)

99.4%

**Relative Specificity**  
(96.8%~99.9%)

Overall Agreement: 98.5% (96.5%~99.3%)

## Ordering Information

Product Code	Product
STR-15STC25	Rapid Response® Strep A Rapid Test Device (with positive and negative control solutions)

To learn more contact your local **Sales Representative**, call us at +1 888 339-9964, or email us at [sales@btnx.com](mailto:sales@btnx.com)